

Base filled to 25mm below door with rounded aggregate conforming with Table 4 of BS EN 12620 : 2002 graded aggregate 14mm to 5mm after cabling has been completed.

Concrete ST5 at sides and rear up to ground level.

Concrete ST5 foundation

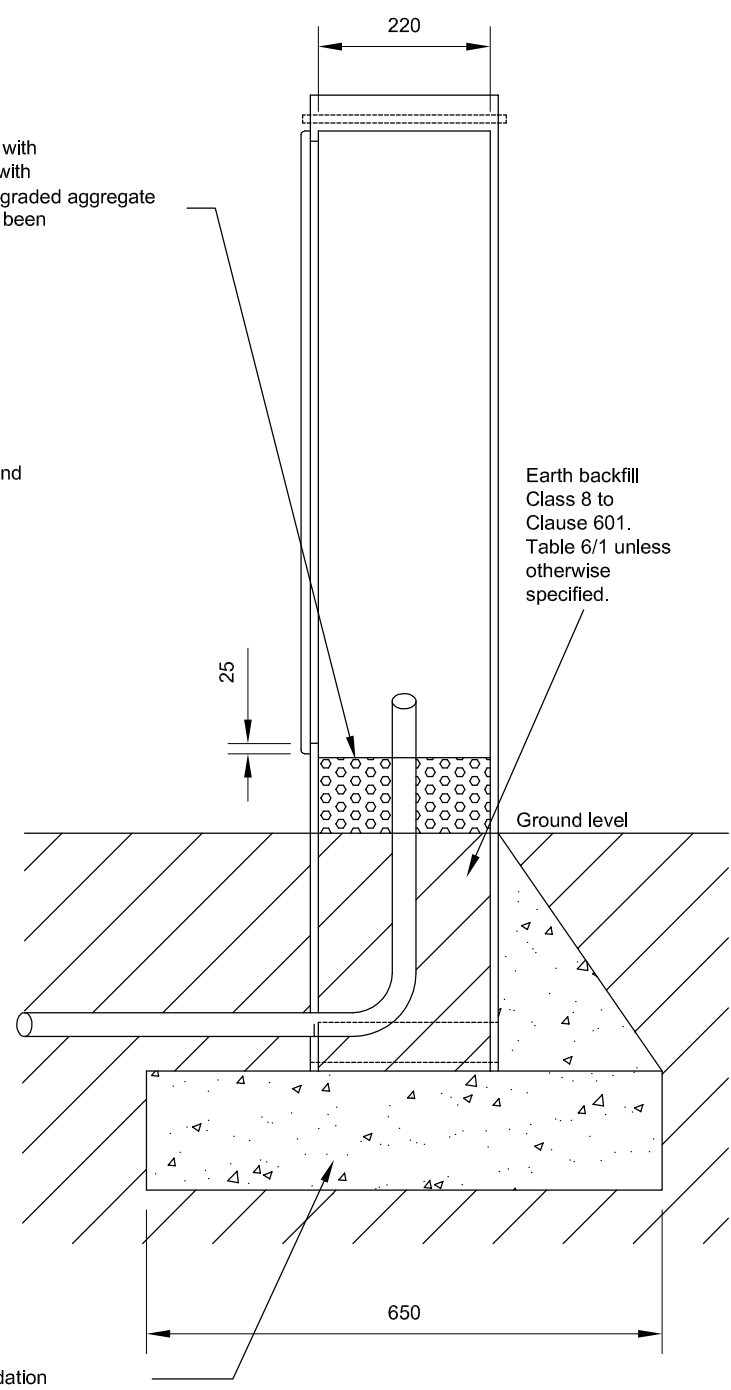

Earth backfill Class 8 to Clause 601. Table 6/1 unless otherwise specified.

Ground level

### NOTES

- All dimensions are in millimetres unless otherwise stated.

| No. | Date | Description |
|-----|------|-------------|
|     |      | AMENDMENTS  |

Drawing No.  
**K85**

HIGHWAY CONSTRUCTION DETAILS

ROAD LIGHTING

FEEDER PILLARS  
TYPICAL PLANTING DETAILS